

FZWZ-SET-001

Mounting tool for twist proof receptacles

With the removal tool, receptacles can be removed from a bore without damaging it. This is also possible with broken receptacles or if you do not have the possibility to knock the receptacles out from the back.

Assembly

- 01 - Handle (GSFZWZ)
- 02 - Thread insert (BZ)
- 03 - Guiding sleeve (HZ)
- 04 - Screw-nut

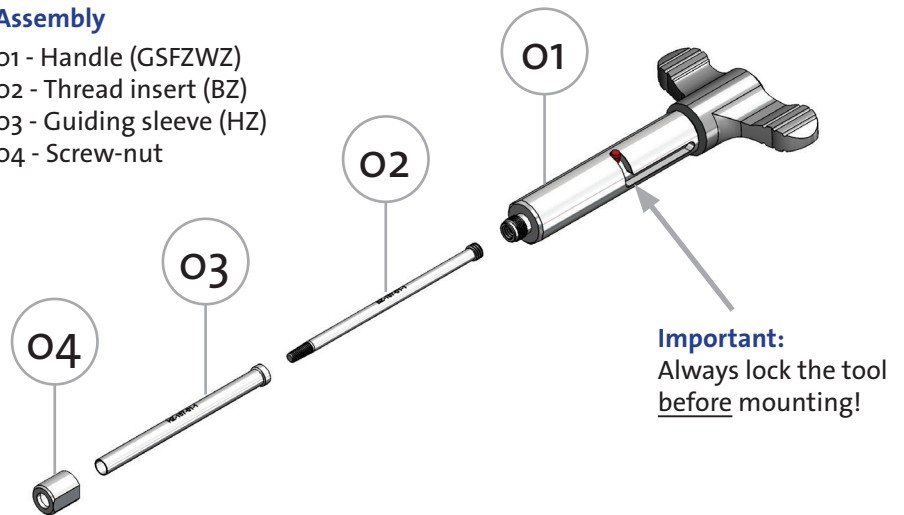

Basic Kit FZWZ-SET-001

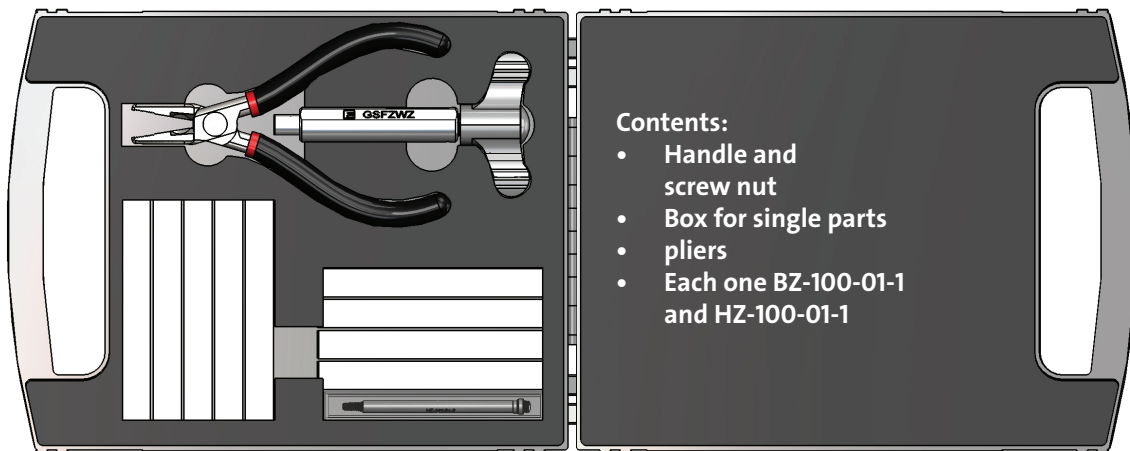

Available guiding sleeves (HZ) and thread inserts (BZ):

Combination:

- BZ-075-01-1 & HZ-075-01-1
- BZ-100-01-1 & HZ-100-01-1
- BZ-100-02-1 & HZ-100-01-1
- BZ-100-02-1 & HZ-100-02-1
- BZ-118-01-1 & HZ-118-01-1
- BZ-157-01-1 & HZ-157-01-1
- BZ-157-01-1 & HZ-157-01-2

Receptacles:

- H121; H075; H175; H176; H310; H561; H701; H863
- H722; H727; H732; H752; H756; H757; H772; H875; H878
- H320; H610; H865
- H100; H502; H708; H731; H751; H805
- H563, HVF3
- H762; H866; H867; H887
- H723; H733; H737; H760; H761; H773; H774; H880; H881; H884; H885, HVF4

Further variants are updated on the homepage under [PRODUCT FINDER/ACCESSORIES-CP/FZWZ](#).

Below you will find step-by-step instructions for handling the tool.

Step-by-step-Instruction

1. Make sure that the handle is locked!
Screw the tool clockwise into the mounted receptacle until a few turns are cut. This is the case when the screwing in becomes stiffer or the guiding sleeve (03) touches the module.

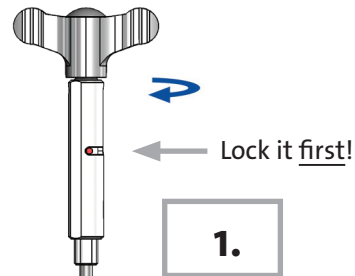

2. Release the lock: Turn the entire tool back slightly counterclockwise so that the lock can be released more easily. Then hold the flattened surfaces (marked red) and turn the handle counterclockwise.

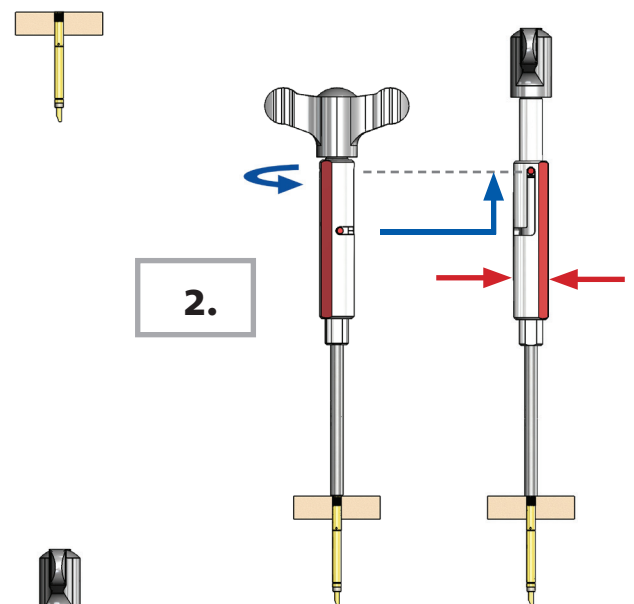

3. Continue turning the tool clockwise. The receptacle pulls upwards from the mounting plate, into the guiding sleeve and can be removed.

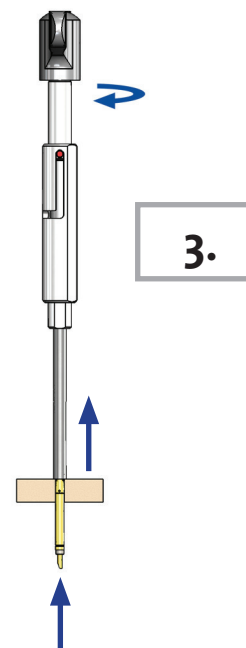

4. Remove the receptacle from the tool with the nipper by screwing it counterclockwise from the tool. The sleeve can be bent by 30°- 90°.

5. For reuse, the thread insert must be screwed all the way down so that the lock can be set.