

# TOOLS / ACCESSORIES

## Hook Wrench

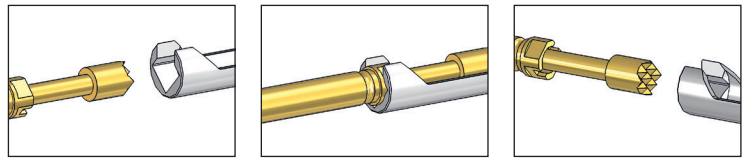

The hook wrench is the standard tool for all probes with square wrench sizes even if the head diameter is larger than the wrench size.



## Socket Wrench



The socket wrench can be used for square wrench sizes if the head diameter is smaller than the wrench size. The tool helps to assemble probes within small centers.

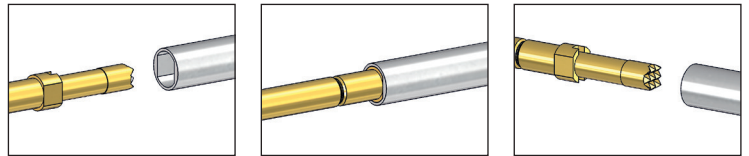

## Screw driver



Screw drivers can be used if the contact area has any support (e.g. serrated honeycomb or slit) and the head has an integrated locking system.

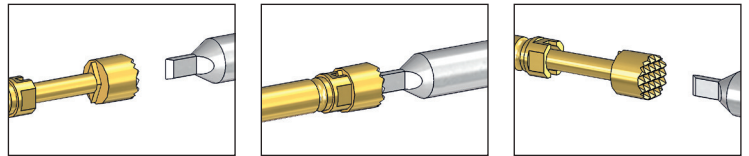

## Tool for Coaxial Probes



For the mounting of large outer conductors FEINMETALL has developed a special tool that enables applications with limited space between the probes.

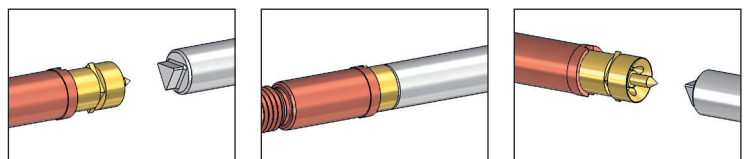

## Tool for Step Probes



For assembly of oversized step probes FEINMETALL has developed a special tool for applications with very limited space between the probes.

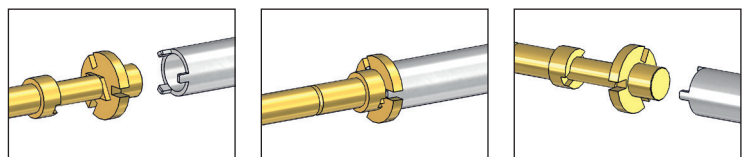

# TOOLS / ACCESSORIES

## Combination Options of Screw-in Tools

Bits and handles can be ordered separately. The handles are color marked due to the wrench size (SW). For each bit a standard handle as well as a handle with ratchet and a bit holder for usage in the cordless screwdriver are available. Each handle can be used with the same bits that are available for all contact probes.

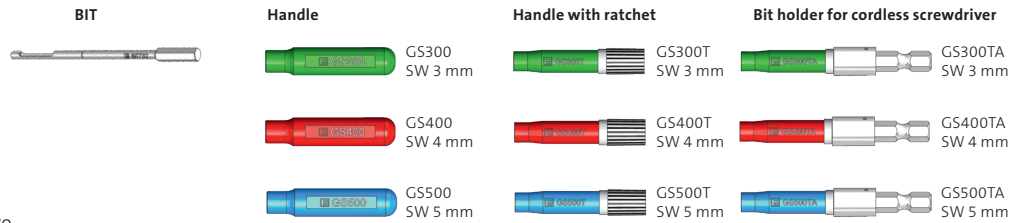

## Screw-in Tools for Step Probes

Probe	max. Tip-Ø	max. Plate-Ø	Shank-ØA	Bit type	FWZ	Handle	BIT	FWZ...T	Handle
F730...SP	0,3 - 0,9	0,4 - 1,0	1,7	Socket wrench	FWZ730	GS300	BIT730	FWZ730T	GS300T
	0,3 - 1,5	0,4 - 1,5	2,0	Hook wrench	FWZ730S1		BIT730S1	FWZ730S1T	
F175...SP	0,3 - 1,5	0,4 - 1,5	2,0	Hook wrench	FWZ730S1	GS400	BIT730S1	FWZ730S1T	GS400T
F731...SP	0,3 - 1,4	0,4 - 1,4	2,4	Socket wrench	FWZ731S1		BIT731S1	FWZ731S1T	
	0,3 - 1,4	0,4 - 1,4	2,4	Socket wrench	FWZ731S1L		BIT731S1L	FWZ731S1LT	
	0,3 - 2,0	0,4 - 2,0	2,8	Hook wrench	FWZ731		BIT731	FWZ731T	
	0,3 - 2,0	0,4 - 2,0	2,8	Hook wrench	FWZ731L		BIT731	FWZ731LT	
	0,3 - 1,0	1,8 - 3,0	1,85	3-point tool	FWZ731SP		BIT731SP	FWZ731SPT	
F732...SP	0,3 - 1,6	0,4 - 1,7	2,7	Socket wrench	FWZ732S2		BIT732S2	FWZ732S2T	
	0,3 - 2,0	0,4 - 2,0	2,8	Hook wrench	FWZ732		BIT732	FWZ732T	
	0,3 - 2,0	0,4 - 2,0	2,8		FWZ732L		BIT732L	FWZ732LT	
	0,3 - 2,7	0,4 - 1,7	3,5	Hook wrench	FWZ732S1		BIT732S1	FWZ732S1T	
	0,3 - 1,5	2,1 - 6,0	2,4	3-point tool	FWZ732SP	BIT732SP	FWZ732SPT		
	0,3 - 1,5	2,1 - 6,0	2,4	3-point tool	FWZ732SPL	BIT732SPL	FWZ732SPLT		
F732...SP1	1,51 - 2,2	2,8 - 6,0	3,1	3-point tool	FWZ732SP1	BIT732SP1	FWZ732SP1T		
F733...SP	3,31 - 6,8	3,5 - 7,0	2,4	3-point tool	FWZ732SP	BIT732SP	FWZ732SPT		
	0,3 - 2,9	0,4 - 3,0	5,0	Socket wrench	FWZ733S1	GS500	BIT733S1	FWZ733S1T	GS500T
	0,3 - 3,3	3,31 - 7,0	4,2	3-point tool	FWZ733SP		BIT733SP	FWZ733SPT	
	0,3 - 3,3	3,31 - 7,0	4,2	3-point tool	FWZ733SPL		BIT733SPL	FWZ733SPLT	
	0,3 - 4,0	0,4 - 4,0	5,0	Hook wrench	FWZ733		BIT733	FWZ733T	
	0,3 - 4,0	0,4 - 4,0	5,0	Hook wrench	FWZ733L		BIT733L	FWZ733LT	
F733...SP1	0,3 - 2,2	3,0 - 4,0	3,1	3-point tool	FWZ732SP1	GS400	BIT732SP1	FWZ732SP1T	GS400T
F737...SP	0,3 - 3,0	0,4 - 3,0	5,0	Socket wrench	FWZ733S1	GS500	BIT733S1	FWZ733S1T	GS500T
	0,3 - 3,9	0,4 - 4,0	5,0	Hook wrench	FWZ733		BIT733	FWZ733T	

# TOOLS / ACCESSORIES

## Screw-in Tools

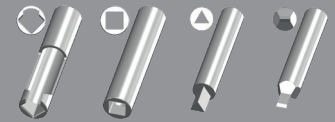

SW	max. Tip-Ø	Shank-ØA	Bit type	FWZ	Handle	BIT	FWZ...T	Handle	Used for (e.g.)
1,0	0,9	1,4	Socket wrench	FWZ730	GS300	BIT730	FWZ730T	GS300T	F730
1,0	1,5	2,0	Hook wrench	FWZ730S1		BIT730S1	FWZ730S1T		F175, F176, F730, PS175
1,4	1,3	2,4	Socket wrench	FWZ731S1	GS400	BIT731S1	FWZ731S1T	GS400T	F731
1,4	2,0	2,8	Hook wrench	FWZ731		BIT731	FWZ731T		F731
1,4	2,0	2,8	Hook wrench	FWZ731L		BIT731L	FWZ731LT		F731
1,7	1,6	2,7	Socket wrench	FWZ732S2		BIT732S2	FWZ732S2T		F732 (C)
1,7	2,0	2,8	Hook wrench	FWZ732		BIT732	FWZ732T		F722, F732 (C), F727, F756, F873, F875
1,7	2,0	2,8	Hook wrench	FWZ732L		BIT732L	FWZ732LT		F722, F732 (C), F727, F756, F873, F875
1,7	2,7	3,5	Hook wrench	FWZ732S1	GS500	BIT732S1	FWZ732S1T	GS500T	F722, F732 (C), F727, F756, F873, F875
1,8	1,9	2,8	Socket wrench	FWZVF100		BITVF100	FWZVF100T		VF100
1,8	2,7	3,5	Hook wrench	FWZVF100S1	BITVF100S1	FWZVF100S1T	VF100		
2,2	2,3	3,5	Socket wrench	FWZVF3S4	GS500	BITVF3S4	FWZVF3S4T	GS500T	VF3
2,2	2,7	3,5	Hook wrench	FWZVF3		BITVF3	FWZVF3T		VF3
2,2	3,1	4,0	Hook wrench	FWZVF3S1		BITVF3S1	FWZVF3S1T		VF3
2,2	2,3	3,5	Socket wrench	FWZVF3S2		BITVF3S2	FWZVF3S2T		VF3, F880
2,2	4,0	5,0	Hook wrench	FWZVF3S3		BITVF3S3	FWZVF3S3T		VF3
2,5	3,1	4,0	Hook wrench	FWZVF4S1		BITVF4S1	FWZVF4S1T		VF4, F887
2,5	4,0	5,0	Hook wrench	FWZVF4	BITVF4	FWZVF4T	VF4, F887		
2,6	2,5	3,8	Socket wrench	FWZ885	GS500	BIT885	FWZ885T	GS500T	F835, F881, F883, F885
2,6	2,5	3,8	Socket wrench	FWZ885L		BIT885L	FWZ885LT		F835, F881, F883, F885
2,6	3,1	4,0	Hook wrench	FWZ885S1		BIT885S1	FWZ885S1T		F835, F881, F883, F885, F886
2,6	4,0	5,0	Hook wrench	FWZ760S1		BIT760S1	FWZ760S1T		F760, F835, F881, F883, F885, F886
2,6	4,9	6,5	Hook wrench	FWZ760S2	BIT760S2	FWZ760S2T	F760, F835, F881, F883, F885, F886		
3,0	3,0	5,0	Socket wrench	FWZ733S1	GS500	BIT733S1	FWZ733S1T	GS500T	F723 (C), F733 (C), F737, F755
3,0	4,0	5,0	Hook wrench	FWZ733		BIT733	FWZ733T		F723 (C), F733 (C), F737, F755
3,0	4,0	5,0	Hook wrench	FWZ733L		BIT733L	FWZ733LT		F723 (C), F733 (C), F737, F755
3,5	4,4	5,5	Hook wrench	FWZ735		BIT735	FWZ735T		F735 (C), F725 (C)
5,0	-	8,0	Hook wrench	FWZ888		BIT888	FWZ888T		F888
6,0	5,9	8,0	Socket wrench	FWZ348	BIT348	FWZ348T	F348, F349		
-	-	4,0	3-point tool	FWZ832	BIT832	FWZ832T	F832		
-	-	3,0	Screw driver	FWZ886	BIT886	FWZ886T	F88617...		

## Screw-in Tools with Signal Indicator for Switch Probes

$\varnothing A$

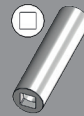

Contact Probe	SW	Shank- $\varnothing A$	FWZ	Batteries	Socket wrench
F880...	2,2	3,7	FWZ880SA	2x AAAA 1,5 V	X
F88890S1101U200S05	5,0	8,0	FWZ888SA	2x AAAA 1,5 V	X
F88890S1102U100S07	5,0	8,0	FWZ888SA1	2x AAAA 1,5 V	X

Batteries not included in delivery

The tool FWZ...SA enables the mounting and correct positioning of switch probes before the final electrical connections are made. The exact switching position can be adjusted by help of the integrated light signal which is illuminated as soon as the switch circuit is closed.

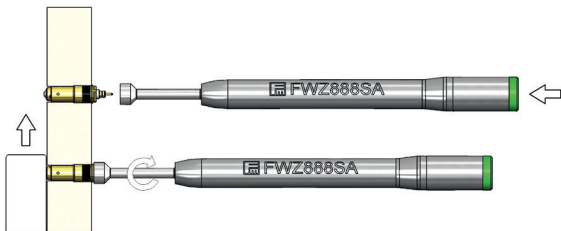
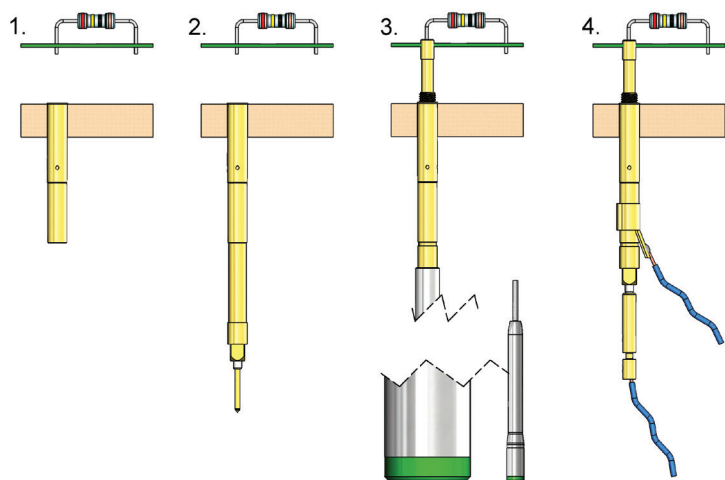

## Tool for detection of blocked or tight plungers

With this tool the correct function of contact probes built in at test modules or fixtures can be tested very quickly (max. spring force 600 cN). Thereby a potential damage of connector elements can be avoided.

- Simple tool with integrated switch probe (F885) and light signal
- Test height (nominal travel) adjustable by threaded sleeve
- Spring force adjustment possible by exchange of the integrated switch probe

### Order code:

32001 (max. Tip- $\varnothing$  4,1 mm)

32002 (max. Tip- $\varnothing$  2,2 mm)

32003 Blocking Tester Set composed of:  
32001 + adaption for 32002

