



# F775C

**High Current Probe 197 mil Robust Version, up to 50 A, Plug-in**

<b>Centers (mm/mil)</b>	5,00 / 197
<b>Current</b>	50,0 A
<b>R typ</b>	<5 mOhm
<b>Temperature</b>	-45°C...+200°C (H)

### Spring Force (cN ±20%)

Version	Preload	Nominal
C	150	300
C	150	500
C	500	1000

### Travel (mm)

Version	Nominal	Maximum
C	4,4	5,5

Pointing Accuracy ±0,10 mm

### Materials and Plating

Plunger	see Tip Style
Barrel	Brass, gold plated
Spring	Stainless steel, unplated
Receptacle	Brass, gold plated

### Accessories

Insertion tool receptacle	FEWZ-735E0
Insertion tool probe	FDWZ-100

### Drill Size (mm)

H775LA	3,98 - 3,99
--------	-------------

### Projection Height (mm)

H775LA with F775...C	10,8
----------------------	------

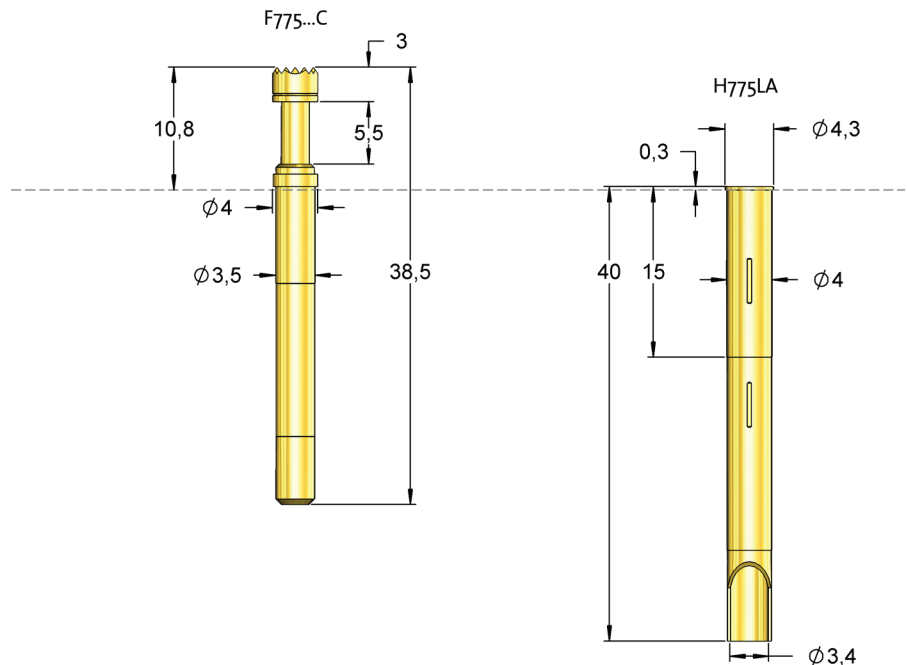

M 1:1



This probe is suitable for applications in burn-in / run-in tests and for functional tests with higher currents.

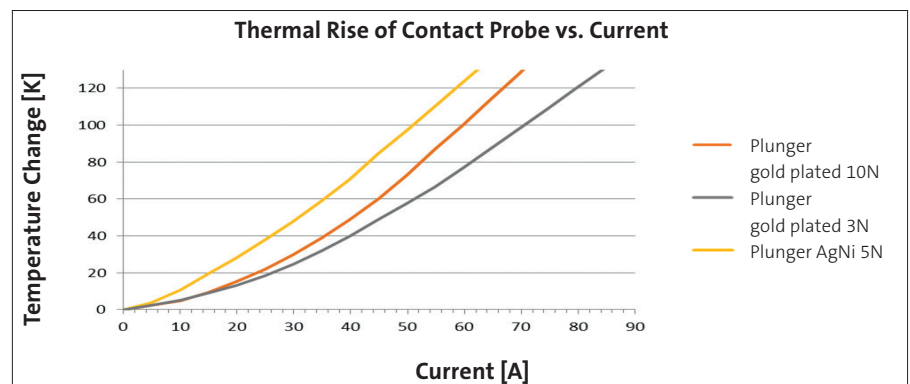

Design with split plunger

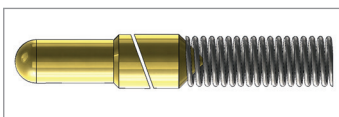

Series	Tip-Ø	Spring Force (cN)
<b>F775 05 B 400 G 300 C</b>		
Tip Style	Material	Plating
Version		

**Material:** B = BeCu, A = AgNi (Silver alloy)  
**Tip-Ø:** 400= 4,00 mm (e.g.)  
**Plating:** G = Gold plated, U = Unplated  
**Version:** C = High Current Version  
**Receptacle:** Order code according drawing

Tip Style	Number	Material	Ø in mm	Plating	Version
	04	B	3,00	G	C
	05	B	4,00	G	C
	06	B	4,00	G	C
	07	B	3,00	G	C
	12	A	4,00	U	C
	17	B	4,00	G	C
	55	B	4,00	G	C