



# F772C

**High Current Probe 100 mil up to 20 A, Plug-in**

<b>Centers (mm/mil)</b>	2,54 / 100
<b>Current</b>	20,0 A
<b>R typ</b>	<10 mOhm
<b>Temperature</b>	-45°C...+200°C (H)

### Spring Force (cN ±20%)

Version	Preload	Nominal
C	50	150
C	50	300

### Travel (mm)

Version	Nominal	Maximum
Standard	4,0	5,0
Pointing Accuracy		±0,08 mm

### Materials and Plating

Plunger	see Tip Style
Barrel	Brass, gold plated
Spring	Stainless steel, unplated
Receptacle	Brass, gold plated

### Accessories

Insertion tool receptacle	FEWZ-772E0
Insertion tool probe	FDWZ-100

### Drill Size (mm)

H772LAS1	1,99 - 2,00
----------	-------------

### Projection Height (mm)

H772LAS1 with F772...C	10,5
------------------------	------

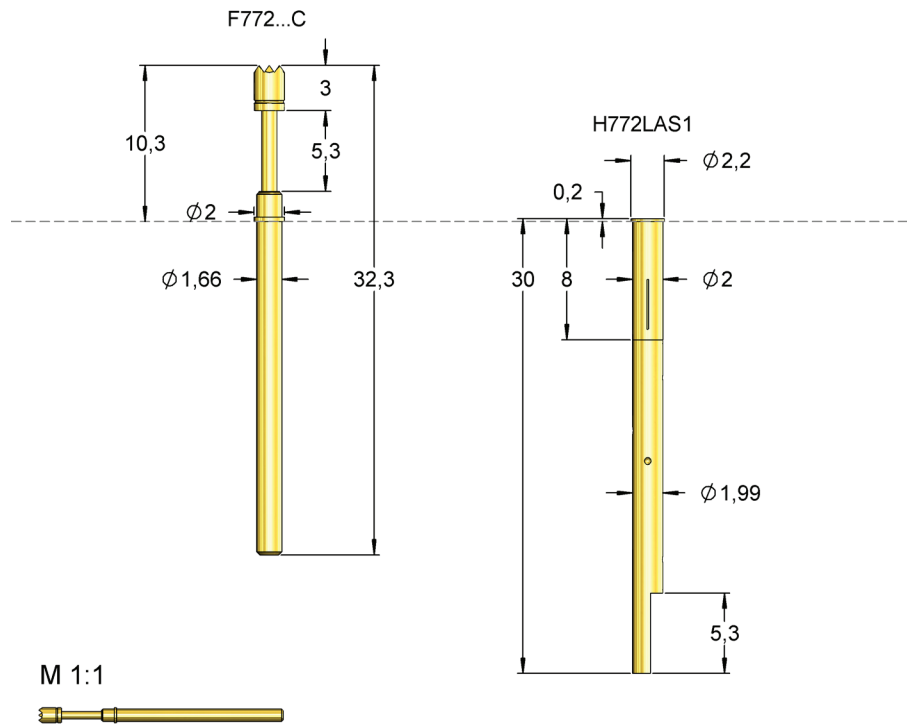

This probe is suitable for applications in burn-in / run-in tests and for functional tests with higher currents.

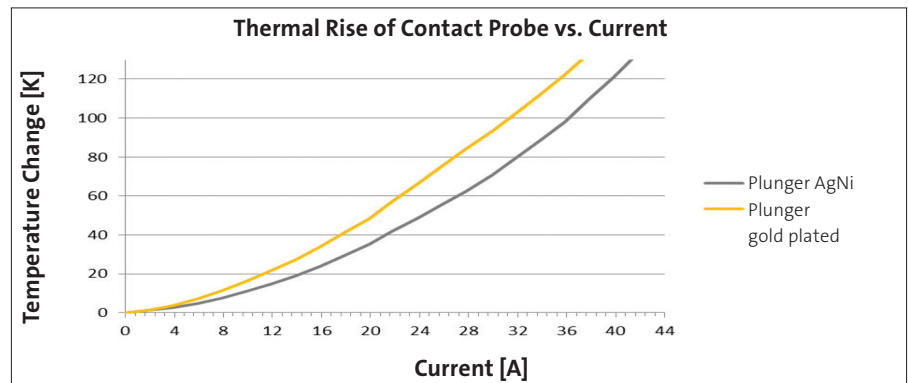

Design with split plunger

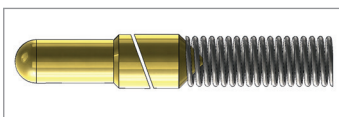

Series	Tip-Ø	Spring Force (cN)
<b>F772 06 B 200 G 300 C</b>		
Tip Style	Material	Plating
		Version

**Material:** B = BeCu, A = AgNi (Silver alloy)  
**Tip-Ø:** 200 = 2,00 mm (e.g.)  
**Plating:** G = Gold plated, U = Unplated  
**Version:** C = High Current Version  
**Receptacle:** Order code according drawing

Tip Style	Number	Material	Ø in mm	Plating	Version
	05	A	2,00	U	C
	06	B	2,00	G	C
	07	B	2,00	G	C
	11	B	1,00	G	C
	14	B	2,00	G	C
	16	B	1,00	G	C
	46	B	2,00	G	C
	55	B	2,00	G	C