



# F760

## Threaded Probe 138 mil Twist Proof with Continuous Plunger

<b>Centers (mm/mil)</b>	3,50 / 138
<b>Current</b>	10,0 A
<b>R typ</b>	30 mOhm
<b>Temperature</b>	-45°C...+100°C

### Spring Force (cN ±20%)

Version	Preload	Nominal
L	50	150
L	80	300
S	50	150
S	80	300

### Travel (mm)

Version	Nominal	Maximum
L	4,0	5,0
S	4,0	5,0
Thread (M)		2,5
Wrench Size		2,6
Pointing Accuracy		±0,08 mm

### Materials and Plating

Plunger	see Tip Style
Barrel	Brass, gold plated
Spring	Music wire, silver plated
Receptacles	Brass, gold plated

### Projection Height (mm)

H760... with F760S	10,5
H760... with F760L	13,2

Series	Number	Spring Force (cN)
<b>F760</b>	<b>81</b>	<b>150</b>
	<b>B</b>	<b>G</b>
	<b>0001</b>	<b>S</b>
	<b>0001</b>	<b>S</b>

Tip Style    Material    Plating    Version

- Material:** B = BeCu  
**Number:** see table  
**Plating:** G = Gold plated  
**Version:** S = Short version, L = Long version, PT = Twist proof insulated cap  
**Receptacle:** Order code according drawing

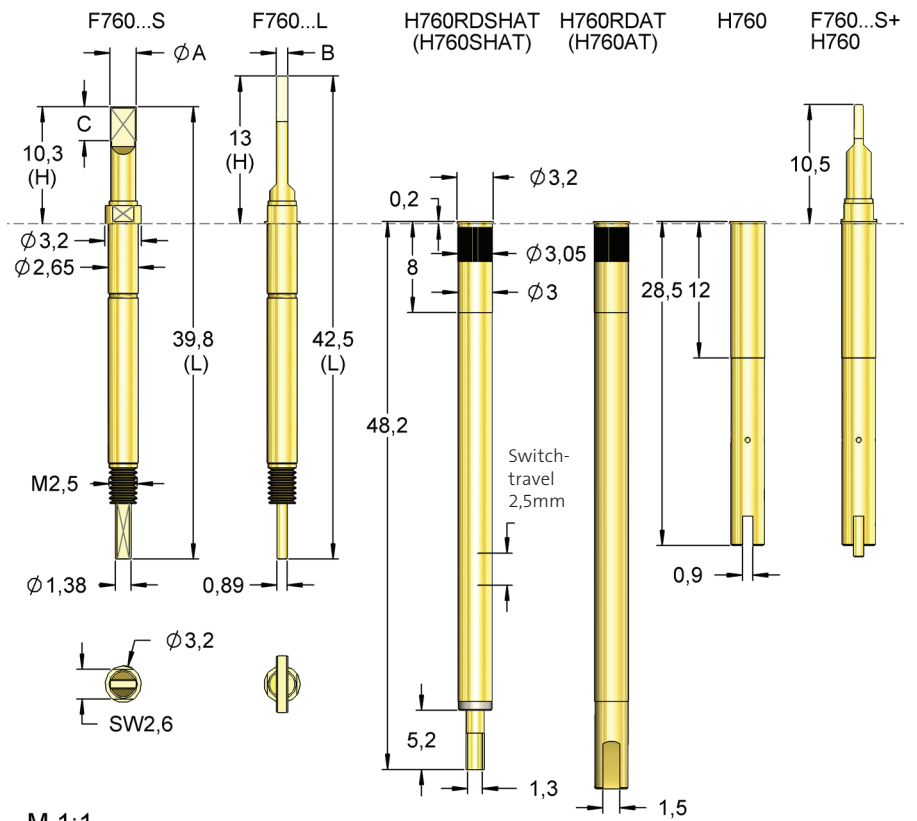

M 1:1



**Airtight I**

Further details of version **F76006B0001G300PT62** (slot 0,7 x 2,1 mm) with twist proof insulation cap see applications on page 83.  
 For the permissible leakage rate see information in the technical introduction.

### Accessories

Alignment tool receptacle	FAWZ761
Screw-in tool probe max. Tip-Ø 4,0 mm	FWZ760S1
Screw-in tool probe max. Tip-Ø 4,9 mm	FWZ760S2
Plug lock	H733VS

### Drill Size (mm)

H760...	2,98 - 2,99
---------	-------------

### KF81

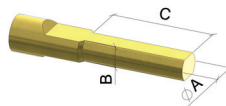

### KF84

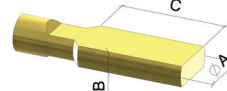

Order code	Number	Ø A	B	C	H	L	Version	Screw-in tool
F76081B0002G300L	81	1,50	0,60	6,00	13,00	42,50	L	FWZ760S1; FWZ760T1
F76081B0001G150S	81	2,00	0,80	4,15	10,30	39,80	S	FWZ760S1; FWZ760T1
F76081B0001G300S	81	2,00	0,80	4,15	10,30	39,80	S	FWZ760S1; FWZ760T1
F76084B0003G300S	84	2,30	0,80	3,00	10,30	39,80	S	FWZ760S1; FWZ760T1
F76084B0003G300L	84	2,30	0,80	3,00	13,00	42,50	L	FWZ760S1; FWZ760T1
F76084B0003G300L	84	2,30	0,80	3,00	13,00	42,50	L	FWZ760S1; FWZ760T1
F76084B0002G150L	84	2,50	0,80	4,00	13,00	42,50	L	FWZ760S1; FWZ760T1
F76084B0002G300L	84	2,50	0,80	4,00	13,00	42,50	L	FWZ760S1; FWZ760T1
F76084B0001G300L	84	2,80	0,50	6,00	13,00	42,50	L	FWZ760S1; FWZ760T1
F76084B0004G150L	84	5,00	1,00	4,00	13,00	42,50	L	FWZ760S2; FWZ760T2
F76084B0004G300L	84	5,00	1,00	4,00	13,00	42,50	L	FWZ760S2; FWZ760T2