



# F733C

**High Current Probe 157 mil Robust Version, up to 25 A, Threaded**

<b>Centers (mm/mil)</b>	4,00 / 157
<b>Current</b>	25,0 A
<b>R typ</b>	<8 mOhm
<b>Temperature</b>	-45°C...+200°C (H)

### Spring Force (cN ±20%)

Version	Preload	Nominal
C	60	150
C	60	300
C	170	600

### Travel (mm)

Version	Nominal	Maximum
C	4,0	5,0
Thread (M)		2,0
Wrench Size		3,0
Pointing Accuracy		±0,10 mm

### Materials and Plating

Plunger	see Tip Style
Barrel	Brass, gold plated
Spring	Stainless steel, unplated
Receptacle	Brass, gold plated

### Accessories

Insertion tool receptacle	FEWZ-774E0
Screw-in tool probe	FWZ733 (T)

### Drill Size (mm)

Receptacle without knurl	2,98 - 2,99
Receptacle with knurl	3,00 - 3,02

### Projection Height (mm)

H733... with F733C	10,5
--------------------	------

Design with split plunger

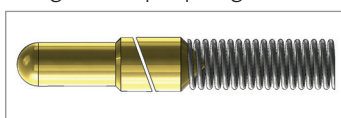

Series	Tip-Ø	Spring Force (cN)
<b>F733</b>	<b>06</b>	<b>230</b>
	<b>B</b>	<b>G</b>
		<b>300</b>
		<b>C</b>

**Material:** B = BeCu, A = AgNi (Silver alloy)  
**Tip-Ø:** 230 = 2,30 mm (e.g.)  
**Plating:** G = Gold plated, U = Unplated  
**Version:** C = High Current Version  
**Receptacle:** Order code according drawing

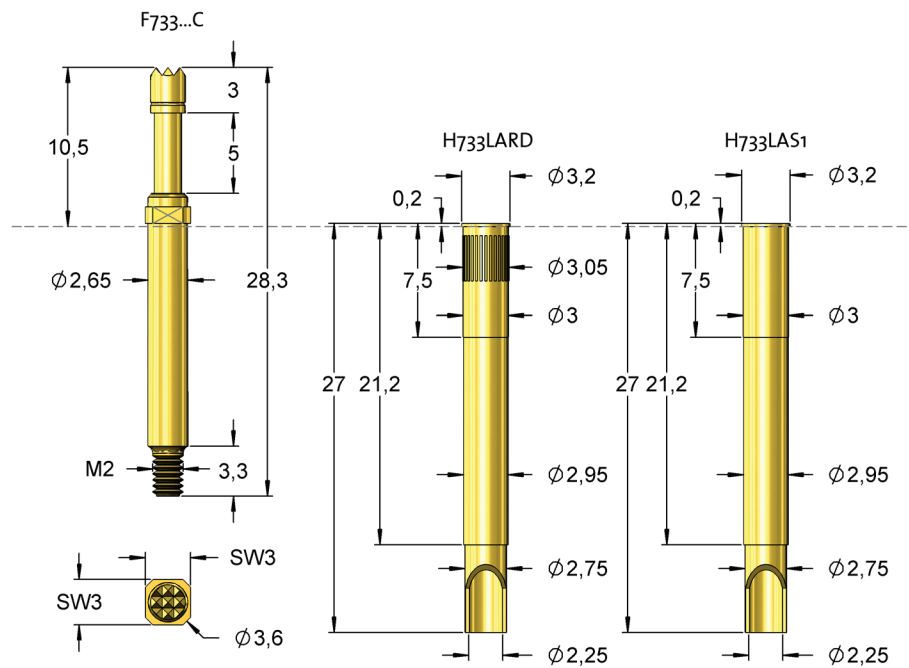

M 1:1

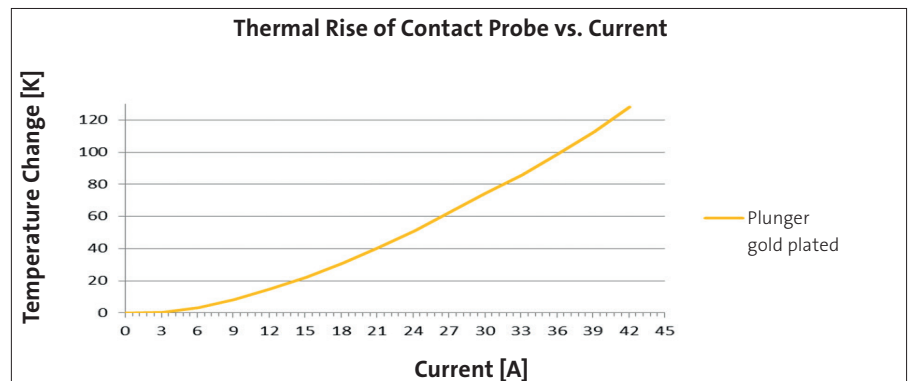

\* Center differing from standard.

Tip Style	Number	Material	Ø in mm	Plating	Version
	05	A	3,00	U	C
	06	B	1,80	G	C
	06	B	2,30	G	C
	06	B	3,00	G	C
	06	B	4,00*	G	C
	07	B	3,00	G	C
	11	B	1,40	G	C
	11	B	1,80	G	C
	12	A	3,00	U	C
	12	B	2,30	G	C
	14	B	2,30	G	C
	16	B	1,00	G	C
	18	B	2,30	G	C