



F732C

High Current Probe 100 mil up to 20 A, Threaded

Centers (mm/mil)	2,54 / 100
Current	20,0 A
R typ	<10 mOhm
Temperature	-45°C...+200°C (H)

Spring Force (cN ±20%)

Version	Preload	Nominal
C	50	150
C	50	300

Travel (mm)

Version	Nominal	Maximum
Standard	4,0	5,0
Thread (M)		1,6
Wrench Size		1,7
Pointing Accuracy		±0,08 mm

Materials and Plating

Plunger	see Tip Style
Barrel	Brass, gold plated
Spring	Stainless steel, unplated
Receptacle	Brass, gold plated

Accessories

Insertion tool receptacle	FEWZ-772E0
Screw-in tool probe	FWZ732 (T)

Drill Size (mm)

Receptacle without knurl	1,99 - 2,00
Receptacle with knurl	2,00 - 2,02

Projection Height (mm)

H732... with F732...C	10,5
H732.../5 with F732...C	15,3
H732.../10 with F732...C	20,3

Design with split plunger

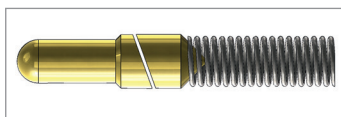

Series	Tip-Ø	Spring Force (cN)
F732	06	200
	B	G
		300
		C

Material:	B = BeCu, A = AgNi (Silver alloy)
Tip-Ø:	200 = 2,00 mm (e.g.)
Plating:	G = Gold plated, U = Unplated
Version:	C = High Current Version
Receptacle:	Order code according drawing

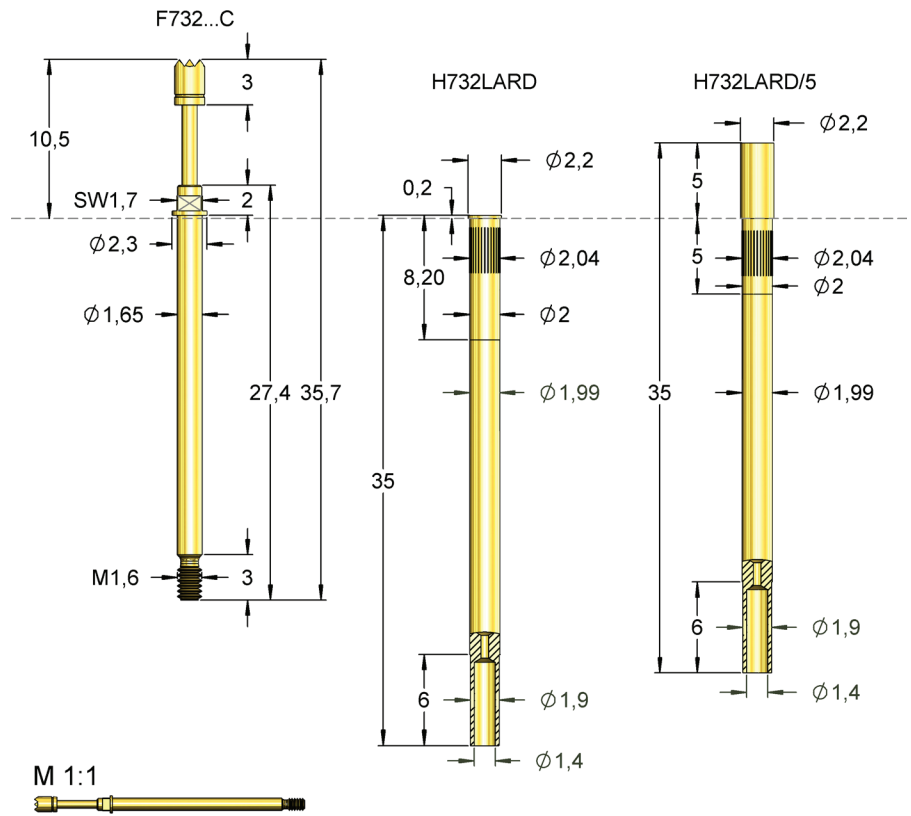

This probe is suitable for applications in burn-in / run-in tests and for functional tests with higher currents.

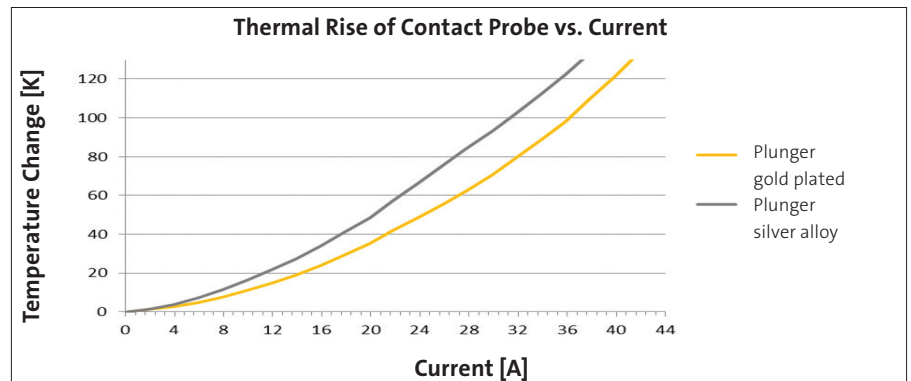

Tip Style	Number	Material	Ø in mm	Plating	Version
	05	A	2,00	U	C
	05	B	2,00	G	C
	06	B	1,80	G	C
	06	B	2,00	G	C
	07	B	1,75	G	C
	11	B	0,65	G	C
	11	B	0,80	G	C
	11	B	1,00	G	C
	16	B	1,00	G	C
	55	B	2,00	G	C