



# F723C

## High Current Probe 157 mil up to 25 A, Threaded

<b>Centers (mm/mil)</b>	4,00 / 157
<b>Current</b>	25,0 (18,0*) A
<b>R typ</b>	<8 mOhm
<b>Temperature</b>	-45°C...+200°C (H)

### Spring Force (cN ±20%)

Version	Preload	Nominal
C	40	80
C	70	150

### Travel (mm)

Version	Nominal	Maximum
C	2,8	3,5
Thread (M)		2,0
Wrench Size		3,0
Pointing Accuracy		±0,08 mm

### Materials and Plating

Plunger	see Tip Style
Barrel	Brass, gold plated
Spring	Stainless steel, unplated
Receptacle	Brass, gold plated

### Accessories

Insertion tool receptacle	FEWZ-713E0
Screw-in tool probe	FWZ733S1 (T)

### Drill Size (mm)

H723LA	2,98 - 2,99
--------	-------------

### Projection Height (mm)

H723LA mit F723...C	7,3
---------------------	-----

### Design with split plunger

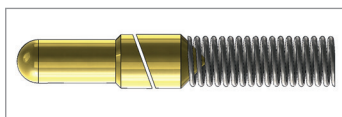

Series	Tip-Ø	Spring Force (cN)
<b>F732 06 B 200 G 300 C</b>		
Tip Style	Material	Plating
		Version

<b>Material:</b>	B = BeCu
<b>Tip-Ø:</b>	230 = 2,30 mm (e.g.)
<b>Plating:</b>	G = Gold plated
<b>Version:</b>	C = High Current Version
<b>Receptacle:</b>	Order code according drawing

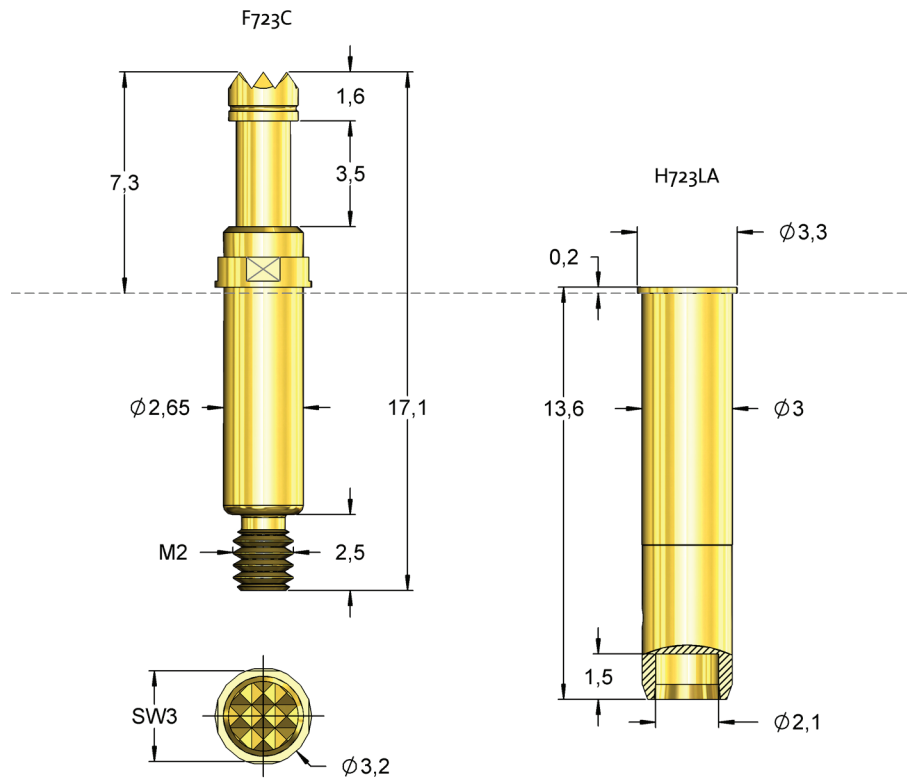

For high current applications with limited available space.  
\*The 80 cN version only allows 18,0 A because of the low contact force.

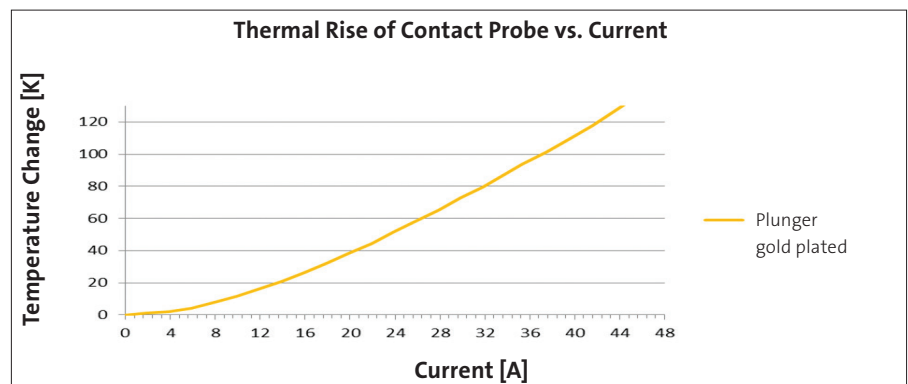

Tip Style	Number	Material	Ø in mm	Plating	Version
	06	B	2,30	G	C
	12	B	2,30	G	C
	14	B	2,30	G	C