



F360C

High Current Probe 145 mil up to 15 A, Threaded

Centers (mm/mil)	3,70 / 145
Current	15,0 A
R typ	<15 mOhm
Temperature	-45°C...+200°C (H)

Spring Force (cN ±20%)

Version	Preload	Nominal
C	50	80

Travel (mm)

Version	Nominal	Maximum
C	0,8	1,2
Thread (M)		2,5
Wrench Size		2,2
Pointing Accuracy		±0,10 mm

Materials and Plating

Plunger	BeCu, gold plated
Barrel	Brass, gold plated
Spring	Stainless steel, unplated
Receptacle	Brass, gold plated

Accessories

Insertion tool receptacle	FEWZ-563E0
Screw-in tool probe	FWZVF3S2

Drill Size (mm)

Receptacle with knurl	3,00 - 3,02
-----------------------	-------------

Projection Height (mm)

H360RD with F360...C	2,6
----------------------	-----

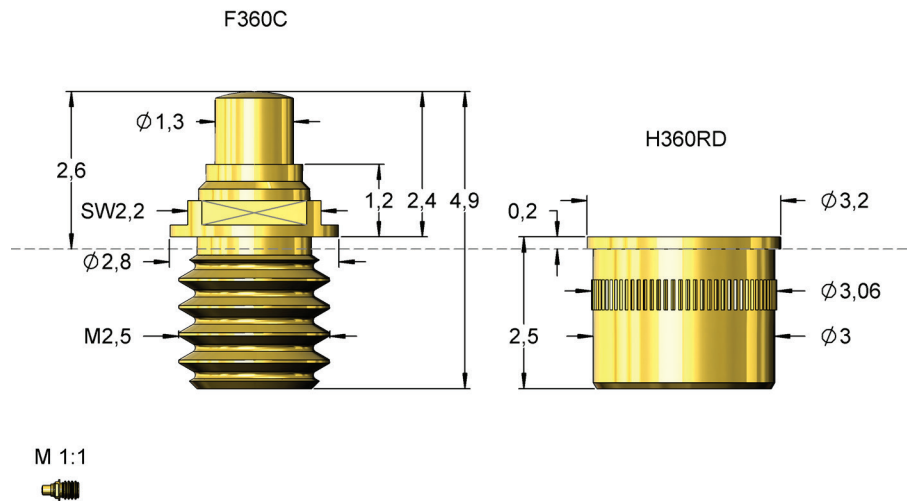

The high current construction ensures a low resistance despite the compact design of the probe. At larger contact surfaces several probes F360C can be mounted next to each other to realize higher currents (e.g. 1860C001).

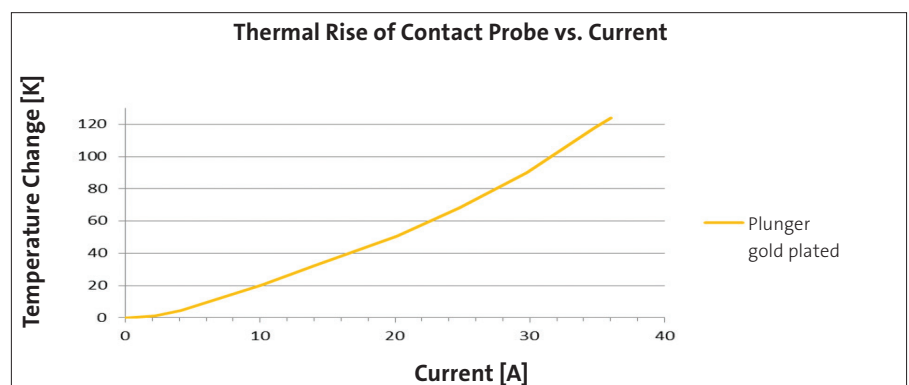

With Bias Design

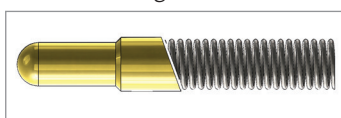

Series	Tip-Ø	Spring Force (cN)
F360 11 B 130 G 080 C		
Tip Style	Material	Plating
		Version

Material:	B = BeCu
Tip-Ø:	130 = 1,30 mm (e.g.)
Plating:	G = Gold plated
Version:	C = High Current Version
Receptacle:	Order code according drawing

Tip Style	Number	Material	Ø in mm	Plating	Version
	11	B	1,30	G	C