

2112153

NEW

TC-P 201 010 RJ 50 Test Connector for RJ-50

Max. Data rate	1 Gbit/s
Voltage	25 VAC / 60 VDC
Current	1,5 A at 25°C
R typ	<20 mOhm
Temperature	-20°C...+75°C

Test solution for RJ-50 connectors
(10 pole).
Applications in data networks,
data transmission, power supplies,
microphones etc.

Features:

- Smooth contact to test item
(front view)
- Easy connection to test system
with RJ-50 cable (rear view)
- Up to 200.000 contact cycles

Series	Pole count	Type
e.g. TC-P 201 010 RJ 50		
Holding device	Contact side	Version

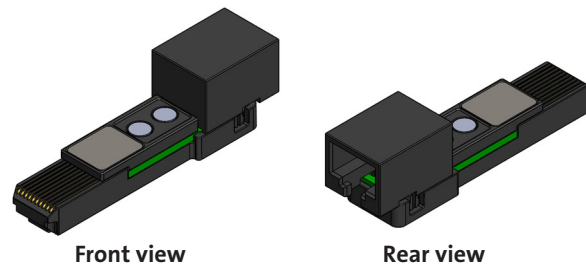
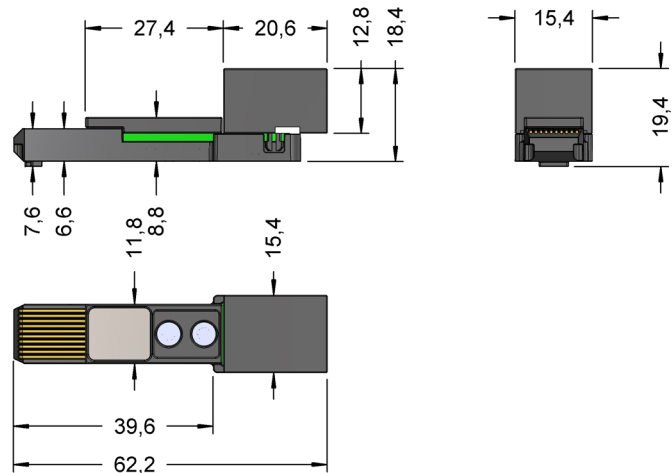

2112201

TC-H 201 Holding Device for Test Connector RJ-xx

Due to the centered seat of the test
connector the holding device allows a
parallel movement of the test connector
and its connection.

- Floating-mounting of test
connectors of $\pm 0,4$ mm in
x- and y-direction
- A torsion angle of up to $1.8^\circ \pm 0.2^\circ$
is possible
- The holding device has a life cycle
of more than 500.000 mechanical
movements
- The holding device is fixed only
by two screws at the upper and
lower ends
- The test connector is attached
to the holding device using only one
locking screw

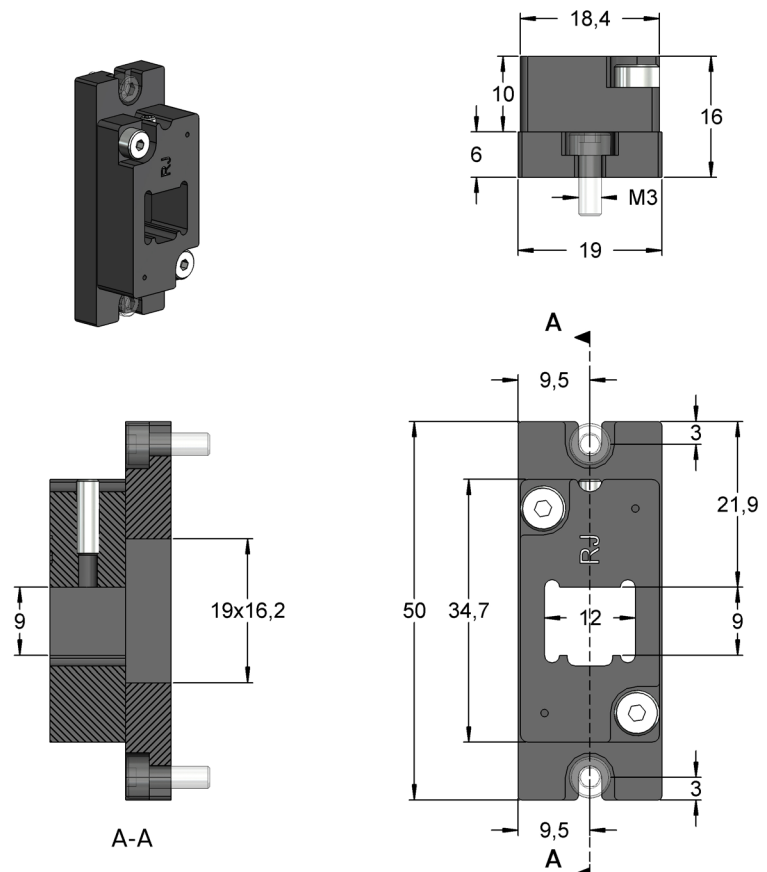

The threaded pin requires a hex wrench
SW1,5.