



**FEINMETALL**  
Contact Technologies

# 1860C004

**High Current Probe 984 mil  
up to 250 A  
Coaxial Design**

<b>Centers (mm/mil)</b>	25,0 / 984
<b>Current (Circular)</b>	250,0 A
<b>Current (Internal)</b>	5,0 A
<b>R typ (circular/internal)</b>	<1/20 mOhm
<b>Temperature</b>	-45°C...+200°C (H)

## Spring Force (cN ±20%)

	Preload	Nominal
Total	-	3150
Internal Cont.	130	300
Circular Cont.	1000	2850

## Travel (mm)

Version	Nominal	Maximum
Internal Cont.	2,8	3,5
Circular Cont.	5,6	7,0
Thread (M)		10,0
Wrench Size		19,0
Pointing Accuracy		< 2°

## Materials and Plating

Internal Cont.	BeCu, gold plated
Circular Cont.	Brass, gold plated
Barrel	Brass, unplated
Spring Internal Cont.	Stainless steel, unplated
Spring Circular Cont.	Stainless steel, unplated

## Drill Size (mm)

Barrel with knurl	20,55 - 20,60
-------------------	---------------

## Contacting an inclined surface

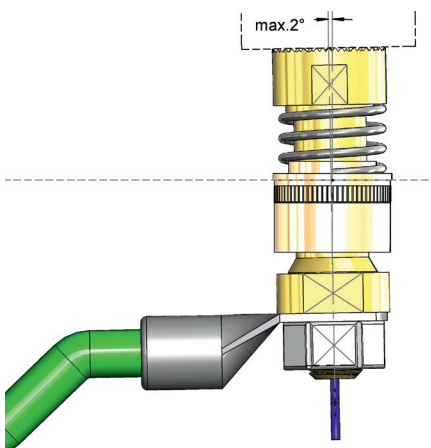

1860C004

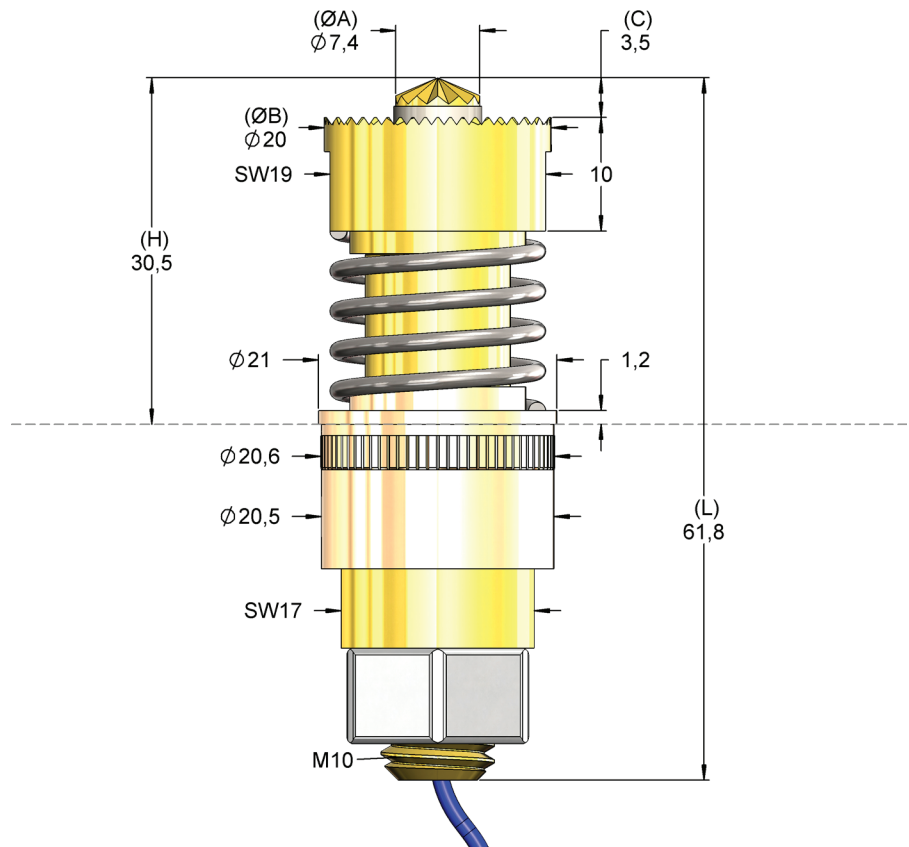

Der 1860C007 adapts to an up to 1,5 degree inclined surface.  
The M5 thread can be mounted with a counternut to a cable eye.

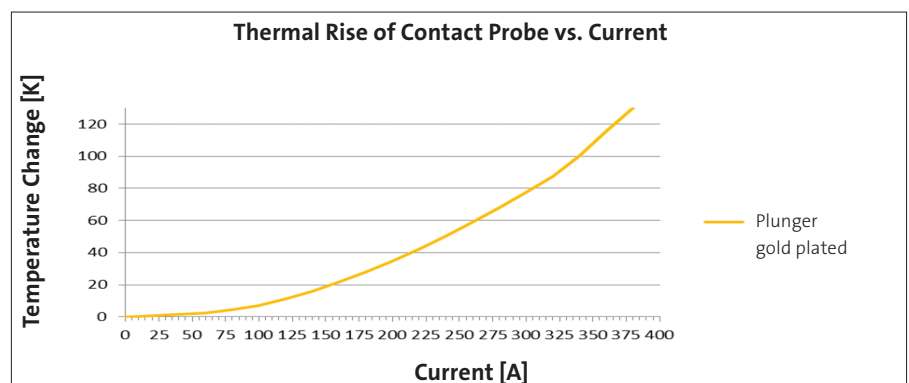

M 1:1

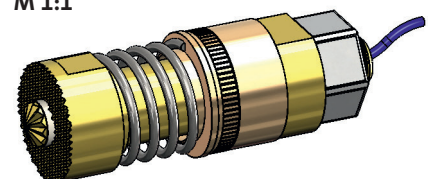

Order Code	Sense Pin	Tip Style	Ø A	Ø B	C	H	L	Version	Screw-in Tool
1860C004		07	7,40	20,00	3,50	30,50	61,80	C	-